

A

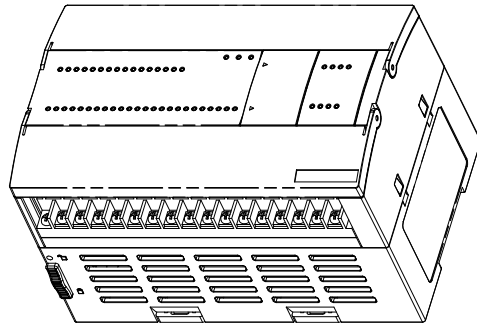

B

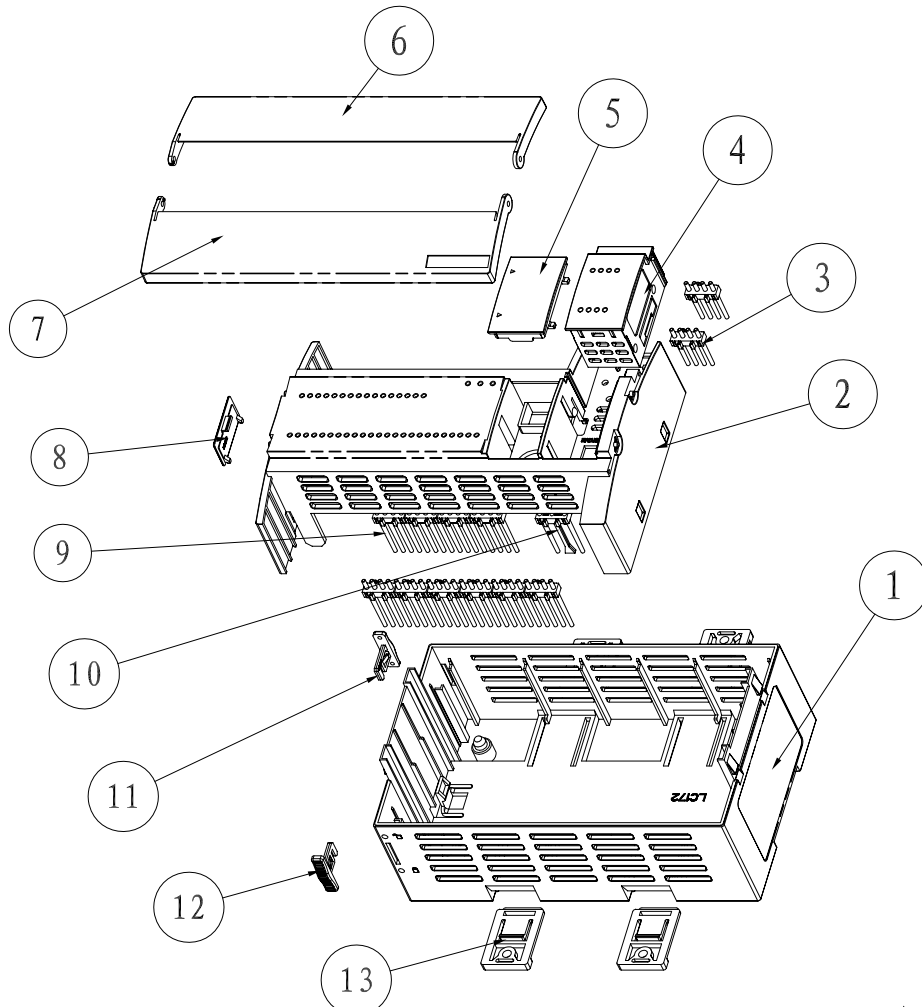

C

D

4

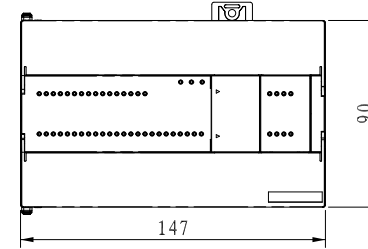
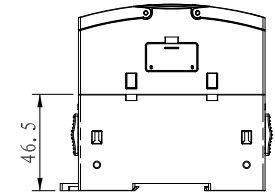
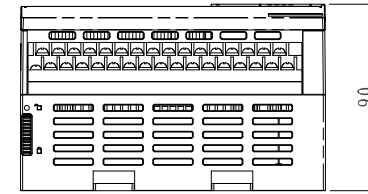

13	LC196	卡簧	4	POM		
12	LC198	上侧锁	1	POM		
11	LC197	下侧锁	1	POM		
10	LC203	导光柱	1	透明PC		
9	LC199	导光柱	10	透明PC		
8	LC207	侧面盖板	1	PC+ABS		
7	LC175	上侧翻盖	1	PC+ABS		
6	LC174	下侧翻盖	1	PC+ABS		
5	LC204	小盖板	1	PC+ABS		
4	LC205	模块上盖	1	PC+ABS		
3	LC206	导光柱	2	透明PC		
2	LC173	上盖	1	PC+ABS		
1	LC172	底座	1	PC+ABS		
<u>序号</u> Number	<u>产品编号</u> Product Code	<u>零件名称</u> Part Name	<u>数量</u> Quantity	<u>材料</u> Material	<u>重量(g)</u> Weight	<u>备注</u> Remarks
<u>制图</u> Drawing	<u>审核</u> Auditing	<u>批准</u> Confirm	<u>客户名称</u> Custom Name	<u>材料</u> Material		
			<u>产品名称</u> Product Name	组装图	<u>图纸比例</u> Drawing Scale	1: 2 A
			<u>产品编号</u> Product Code	22-112	<u>视图</u> Project View	(mm)
共 页 第 页			宁波三和壳体公司 NINGBO SANHE ENCLOSURE CORPORATION		中国·宁波慈溪 TEL:+86(574)63226910 FAX:+86(574)63226900	

1

2

3

4

5

6

D